



MAG'S LANDING

1525 Kautz Road, West Chicago, Illinois

Office Space For Lease At DuPage Airport

Office Space for Lease

RECI is pleased to present **Mag's Landing** located in West Chicago, Illinois. This single story office building is situated at the DuPage Airport, adjacent to the Flight Center entrance at Kautz Road and International Drive.

Mag's Landing is conveniently located near numerous amenities including Charlestowne Mall, Super Target, Pheasant Run Resort & Spa and Prairie Landing Golf Club.

- **Available Spaces:**
 - Suite 600 - 6,440 sf
 - Suite 800 - 3,500 sf
 - Suite 1700 - 1,500 sf
- Fiber optic available
- Individual tenant entrances
- Individual heating and air conditioning units
- Ample parking - 5/1000
- 24-hour access



Real Estate Consultants, Inc.
18 E. Dundee, Bldg. 4, Suite 140
Barrington, IL 60010
P: (630) 942-7000
F: (630) 495-7393
www.RECIUSA.com

Annette LaTart
Commercial Consultant
(630) 942-7000 x 2114
alatart@reciusa.com

No warranty or representation, expressed or implied, is made as to the accuracy of the information contained herein and same is submitted subject to errors, omissions, change of price or other conditions, withdrawal without notice, and to any special listing conditions imposed by our principals. Owner, Owner's stockholders and/or its agents or employees may be involved in the ownership of the listing, and in which case, ownership is an Illinois-licensed real estate broker.



MAG'S LANDING

1525 Kautz Road, West Chicago, Illinois

Floor Plan

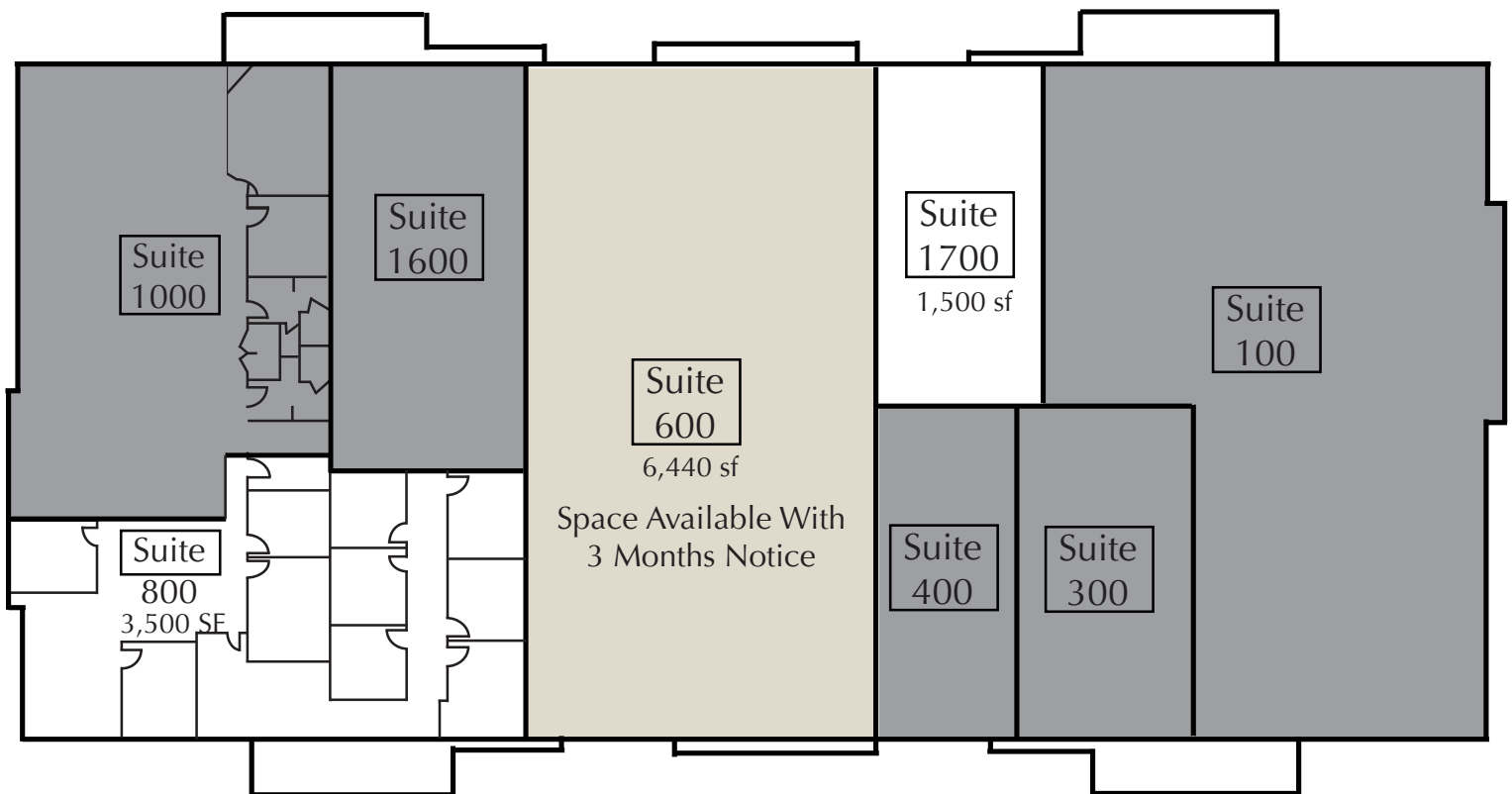

Dark Gray - Leased

Real Estate Consultants, Inc.
18 E. Dundee, Bldg. 4, Suite 140
Barrington, IL 60010
P: (630) 942-7000
F: (630) 495-7393
www.RECIUSA.com

Annette LaTart
Commercial Consultant
(630) 942-7000 x 2114
alatart@reciusa.com

No warranty or representation, expressed or implied, is made as to the accuracy of the information contained herein and same is submitted subject to errors, omissions, change of price or other conditions, withdrawal without notice, and to any special listing conditions imposed by our principals. Owner, Owner's stockholders and/or its agents or employees may be involved in the ownership of the listing, and in which case, ownership is an Illinois-licensed real estate broker.