



City of West Chicago

Community Development Department
475 Main Street, West Chicago, IL 60185
Phone: (630) 293-2200 x 131 / FAX: (630) 293-1257

APPLICATION FOR PLAN EXAMINATION & BUILDING PERMIT

Permit Number:	<u>2020010</u>
Date Received:	<u>12, 1, 20</u>
Permit Fee: \$	_____
Approved:	_____

Homeowner's Association? _____

_____ (Project Address) _____ (Subdivision)
 _____ (Zoning) _____ (Lot Number) _____ (P.I.N.)

_____ (Property Owner) _____ (Phone)
 _____ (Street Address) West Chicago IL 60185
 _____ (City, State Zip)

_____ (Name of Applicant) _____ (Phone and FAX)
 _____ (Address) _____ (Email Address)

none _____ (General Contractor) _____ (Address) _____ (Phone)
 _____ (Electrical Contractor) _____ (Address) _____ (Phone)
 _____ (Plumber) _____ (Address) _____ (Phone)
 _____ (Roofer) _____ (Address) _____ (Phone)

- WORK TO BE DONE:
- Addition to existing building
 - Remodel
 - Driveway (new or repair)
 - Plumbing (only)
 - Water meter (lawn sprinkler)
 - Other: _____

- Patio
- New building
- Siding
- Electric (only)
- Water meter (replacement)
- Shed

- TYPE OF STRUCTURE:
- Single family (detached)
 - Townhouse
 - Commercial
 - Industrial
 - Other: Greenhouse
- SUBMITTING WITH APPLICATION: Survey Building Plan

ESTIMATED TOTAL COST OF PROJECT: \$ 7000

STATEMENT OF APPLICANT:

I hereby certify that the above statements are true and accurate, agree to comply with the provisions of the Ordinances of the City of West Chicago, affirm that the proposed work is authorized by the owner of record, and that I have been authorized by the owner to make this application as his/her agent.

_____ (Signature of Applicant) _____ (Print Name) 11 / 30 / 2020 (Date)

CITY #7

BLDG DEPT COPY

Greenhouse Construction Elevation

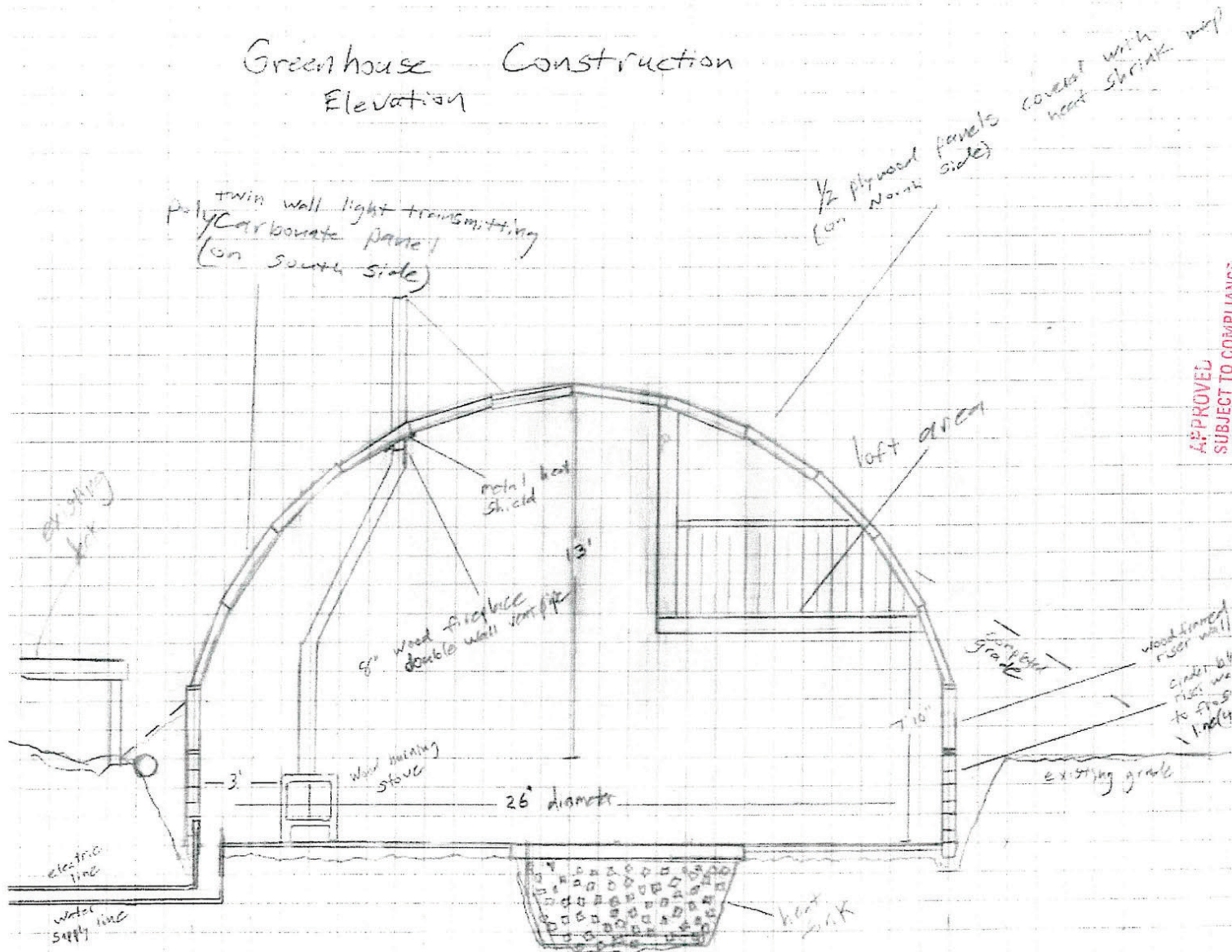

APPROVED
SUBJECT TO COMPLIANCE
WITH THE CITY OF WEST CHICAGO, IL
CODES
DATE
BY

PERMIT #

Greenhouse Construction floor plan

26' diameter Geodesic dome on 5'6" riser wall

2x6 dome frame covered with plywood and polycarbonate panels

wood boring stove

Loc. for 2x6 (approx. 12x6 sq)

Existing Deck

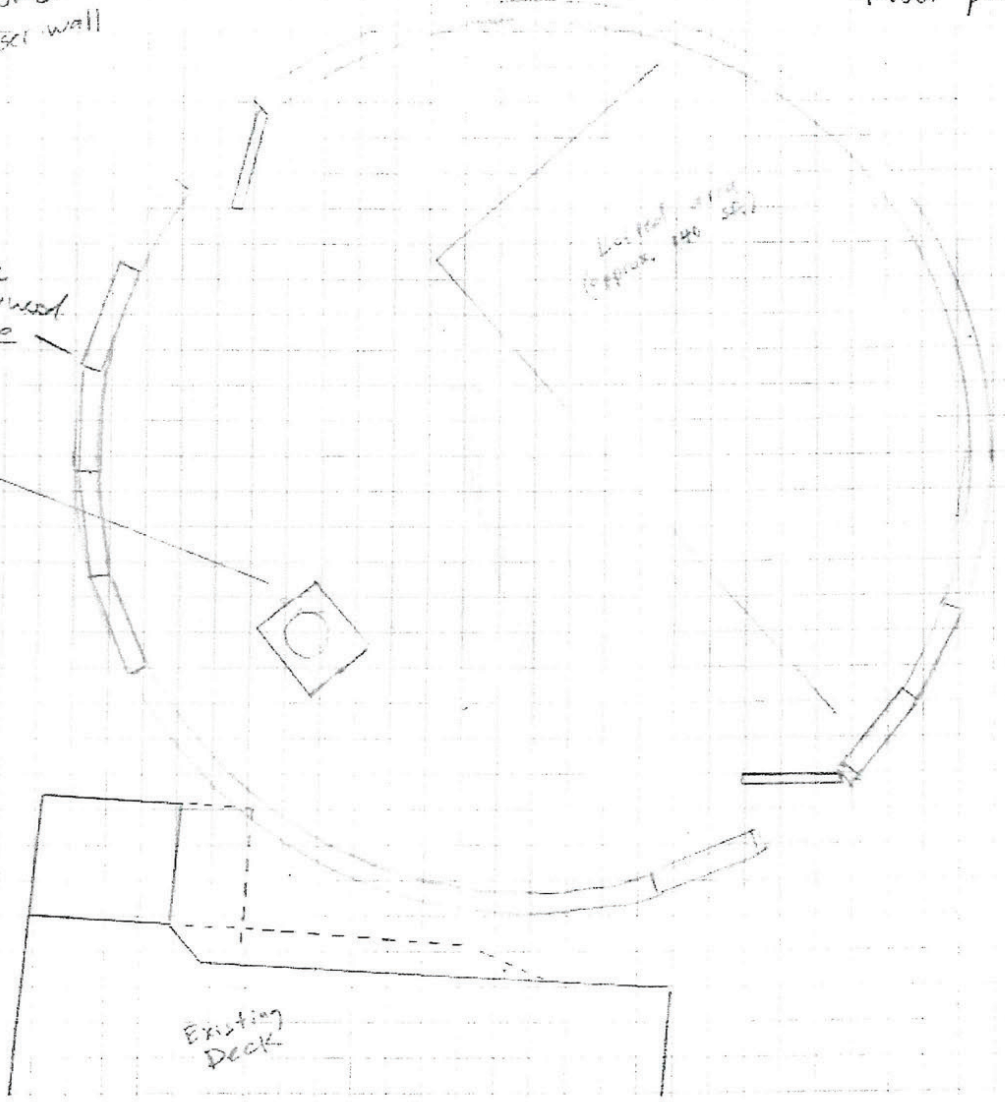

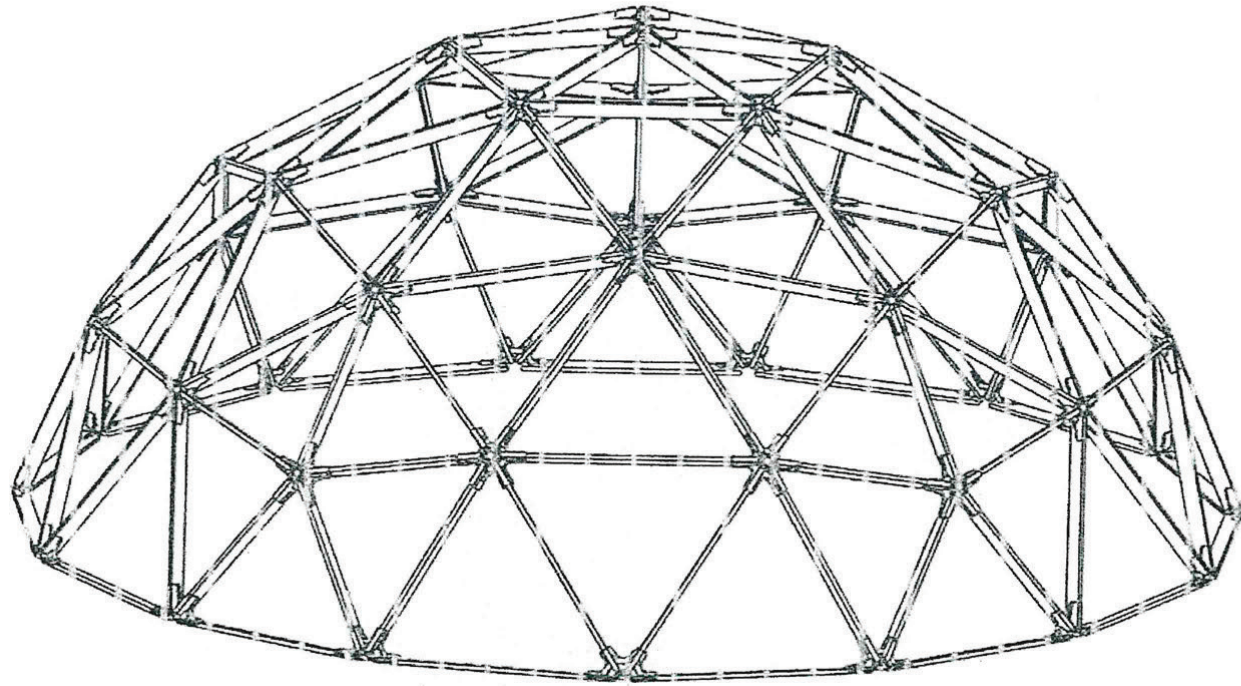

17. Add additional side fasteners and check that all fasteners are tight.

PLAT OF SURVEY

OF
LOTS 8 AND 9 AND THE VACATED ALLEY ADJACENT TO SAID LOTS IN BLOCK 2 IN BARBER'S ADDITION TO THE TOWN OF TURNER, A SUBDIVISION OF PART OF THE SOUTHWEST QUARTER OF THE NORTHWEST QUARTER OF SECTION 10, TOWNSHIP 39 NORTH, RANGE 9, EAST OF THE THIRD PRINCIPAL MERIDIAN, IN DUPAGE COUNTY, ILLINOIS.

