

GENERAL NOTES:

t = THICKNESS OF PAVEMENT

CONTRACTION JOINTS SHALL BE 15' MAX FOR PCC PAVEMENT AND 25' MAX FOR HMA PAVEMENT

TRANSITION FROM FULL HEIGHT CURB TO DEPRESSED CURB SHALL BE MADE AT THE MINIMUM RATE OF 2-INCH PER FOOT.

CONSTRUCTION SHALL BE IN ACCORDANCE WITH STATE STANDARD 606001

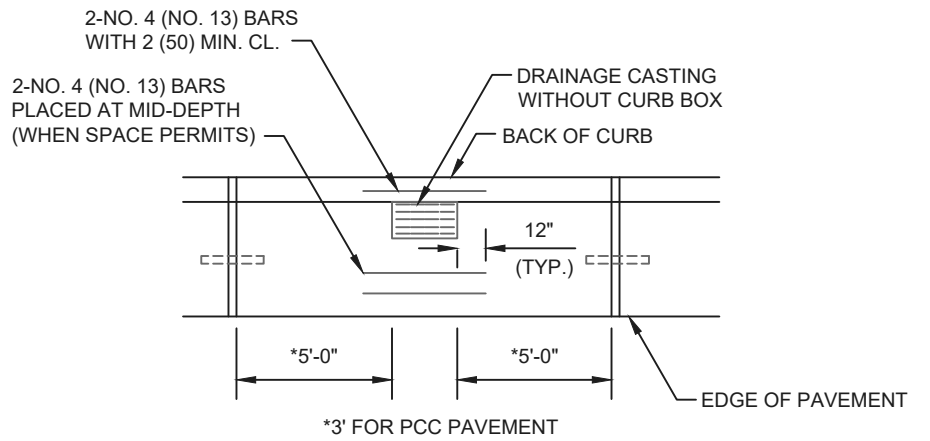

STANDARD RDY-001

REVISIONS	